

Stainless Steel Fume Hood Labframe Kit

4' Fume Hood
Cat. No. 14224-400

5' Fume Hood
Cat. No. 14224-402

6' Fume Hood
Cat. No. 14224-404

8' Fume Hood
Cat. No. 14224-406

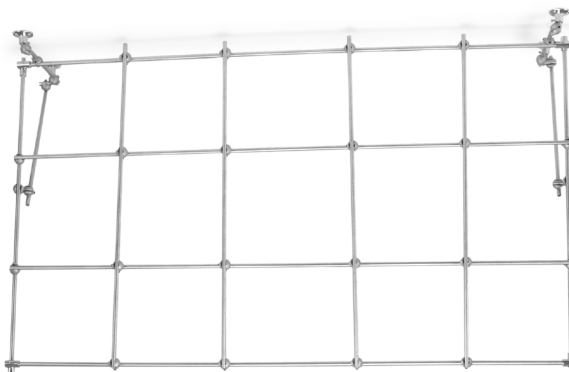

MANUFACTURED BY:

HENRY TROEMNER LLC

201 Wolf Drive 1 PO Box 87 1 Thorofare, NJ 08086-0087
Phone: 856-686-1600 1 Fax: 856-686-1601
www.troemner.com 1email: troemner@troemner.com

715744-00

4-040-INS Rev. (7/02)

INTRODUCTION

Required for assembly: flat head screwdriver, allen wrench (provided) for lattice connectors. Open the packing tubes and account for all listed items. Read the instruction sheet completely prior to assembly of the components. Separate the rods by length, and identify all components by name (description is typically on each bag).

ASSEMBLY

1) Outer frame - Use four (4) rod-end connectors, two (2) horizontal rods and two (2) vertical rods to create outer frame. It is generally easiest to lay these out on the floor horizontally to assemble. (Rod depth may require adjustment to make square).

Once the basic frame is completed place the lattice connectors on the top outer horizontal rod in the approximate location you desire. Add the corresponding lattice connectors on the opposite rod, place the vertical rods in connectors, and tighten.

Turn your frame over and add the horizontal rods as above, placing a lattice connector at intersection of rods, every 12".

2) Base support assembly - Start by placing a 2" rod in each of the feet, tighten fully, attach a lattice connector to each 2" rod (Fig.1). Place base support rod in base support assembly, tighten fully. Attach two (2) additional lattice connectors to the base support rod, these connectors are used to attach outer frame and rear support assembly. Place outer frame on the base support assembly. (Fig. 2)

3) Rear support assembly - Rear support rods connect the outer frame and base support assembly, which adds stability (Fig 2). Use four (4)- 2" rods, 8 lattice connectors and base support rods (see Fig 2a, 2b). Hand tighten all components, adjust frame assembly as necessary. Once all the components are in place and aligned properly, re-tighten all components.

Next, permanently mount the laboratory frame into the fume hood using screws provided with the laboratory frame feet. Do not attempt to mount components on frame until all feet are securely held in place. Your frame is now ready for use.

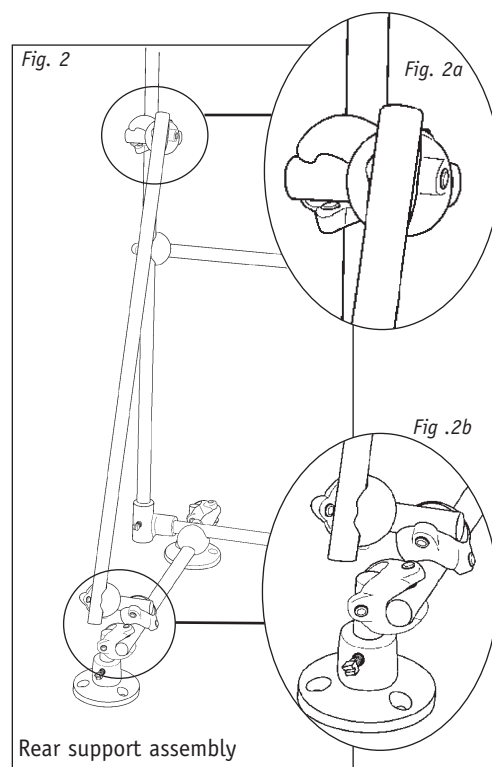
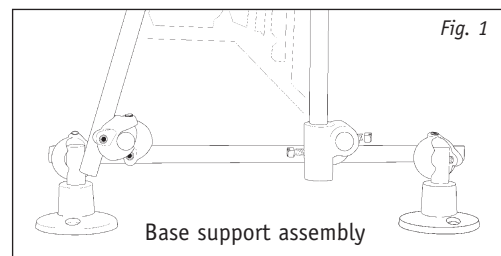

For help in assembly, or questions on components, please feel free to contact Henry Troemner LLC, at 1-800-260-9998.

Fume Hood Lab-Frame Kit Component Quantities

	Horizontal Rod	Qty	Vertical Rod	Qty	Base Rod	Qty	Rear Support Rod	Qty	2 inch Rod	Lattice Connector	Rod-End Connector	Lab-Frame Foot
4 foot kit	38"	4	36"	4	12"	2	18"	2	8	30	4	4
5 foot kit	50"	4	36"	5	12"	2	18"	2	8	34	4	4
6 foot kit	62"	4	36"	6	12"	2	18"	2	8	38	4	4
8 foot kit	86"	4	36"	8	12"	3	18"	2	10	45	4	6

