

# INSTRUCTIONS AND REPAIR PARTS LIST

CQB20 Brooder has a heater for brooding. CQGO20 Growout Pen is identical to CQB20 except that it has no heater. CQB600 Caster Base is designed for either CQB20 or CQGO20.

## CQB20 CHICK AND QUAIL BROODER CQGO20 GROW OUT PEN CQB600 CASTER BASE ASSEMBLY



### WARNING

Be sure Power Cord Assembly is not connected during installation or cleaning. Remove heater before cleaning. Do not touch either lug of the thermostat if power source is connected. Touch only the adjustment knob. Do not defeat electrical ground afforded by 3-prong Cord Assembly. Model AT10 Adjustable Thermostat and Model BRHTR20 should be repaired only by a qualified electrician. Failure to follow these and other safety precautions could result in electrical shock causing serious injury or death!

### READ ALL DIRECTIONS CAREFULLY BEFORE BEGINNING INSTALLATION

**REPAIR PARTS LIST** - See Exhibit A for location of parts.

Ref. No.	Part No.	Description	Quantity	Ref. No.	Part No.	Description	Quantity
1	CQB201	Leg	4	21	OF118*	Washer, 3/16 Rivet Burr, Z	68
2	CQB208	Front Panel	1	22	OF415*	Nut, 10-24 Nylon Lock Nut, SS	68
3	CQB209	Back Panel	1	23	OF3*	Screw, 10-24 x 3/8 SL TR Mach, Z	15
4	CQB210	Side Panel (Feeder Side)	1	24	OF53*	Nut, 10-24 HX Mach Screw, Z	15
5	CQB211	Side Panel	1	25	VP115*	Adjust Screw, 1/4-20 Wing Plastic	5
6	CQB203	Drop Pan Channel	2	26	OF335*	Nut, 1/4-20 Whiz, Z	5
7	CQB204	Sliding Window Channel	6	27	43814*	S Hook	1
8	CQB202	Angle Brace	2	28	R7	Pilot Bulb, 7.5 Watt	2
9	CQB212	Top Cover	2	Model CQB600 Caster Base is used for stacking up to 4 or 5 brooders in one stack. We recommend a maximum of 4 brooders in one stack but our base will handle 5 brooders.			
10	CQB205	Floor Bracing	3		CQB600	Caster Base Assembly	
11	CQB206	Floor Crossing Brace	3	28	70507	Caster	4
12	CQB215	Floor Screen	1	29	70252	Caster Bracket	4
13	CQB207	Drop Pan	1	30	OF341	1/4-20 x 1/2 Carriage Bolt, Zinc	8
14	CQB216	Window Screen	2	31	OF335	Nut, 1/4-20 Whiz, Z	8
15	CQB214	Window Cover	2	32	OF139	Bolt	8
16	CQB213	Back Door	1	33	OF114	Lockwasher	8
17	CQB502	Feeder	1	34	OF59	Nut, HX HD Machine, Z	8
NOTE: If you purchased Model CQGO20, a single growout pen, you will not receive Ref. No. 18. Caution: BRHTR20 should only be repaired by a qualified electrician.				35	CQB601	Long Bracing	2
18	BRHTR20	Heating Assembly with Thermostat	1	36	CQB602	Short Bracing	2
	CQB20-HDWE	Hardware Bag Assembly					
	Hardware Bag Assembly includes items marked with *						
19	OF44*	Screw, 10-24 x 3/4 SL TR HD Mach, Z	8				
20	OF214*	Screw, 10-24 x 1/2 SL TR HD Mach, Z	60				

### MODEL NUMBER

The MODEL NUMBERS are: CQB20 Brooder; CQGO20 Grow-Out Pen and CQB600 Caster Base Assembly

### WHEN ORDERING PARTS

- (1) Show MODEL NUMBER and NAME: Example - CQB20 Brooder
- (2) Show PART NUMBER and FULL DESCRIPTION of part: Example - CQB216 Window Screen

### HOW TO ORDER PARTS

Repair parts may be ordered from your dealer.

**Brower**

EQUIPMENT FOR POULTRY • LIVESTOCK • PETS

P O BOX 2000, HOUGHTON, IOWA 52631 USA

TELEPHONE 319-469-4141 • FAX 319-469-4402 • 800-553-1791

E-mail: broweriowa@aol.com

Web: www.browerequip.com

ISBCQB20  
PRINTED IN U.S.A.

## **ASSEMBLY INSTRUCTIONS:**

**STEP 1:** Attach Window Channels (Ref. No. 7) to Front Panel, Back Panel, and Side Panel, (Ref. Nos. 2, 3, 5), using four (4) 10-24 x 1/2" screws, 3/16" washers, and 10-24 locknuts, (Ref. Nos. 20, 21, 22) each. Window channel should fit flat against panels with form openings facing each other. Tighten all Window Channels.

**NOTE:** When using Ref. Nos. 20, 21, 22, always place washer with screw, insert screw and washer through the part and then place on the nut.

**STEP 2:** Attach Drop Pan Channels (Ref. No. 6) to the inside of both Side Panels, (Ref. No. 4 and 5) using five (5) (Ref. Nos. 20, 21, 22) on each. Make sure three (3) 1/4" holes on each drop pan channel are facing toward top.

**NOTE:** Ref. No. 22 Locknut must be placed on the outside of the Unit, so that the Drop Pan (Ref. No. 13) may slide in and out after assembly. Tighten locknuts.

### **DO NOT TIGHTEN ANY FASTENERS UNTIL INSTRUCTED TO DO SO.**

**STEP 3:** Attach Two (2) Legs (Ref. No. 1) to each Side Panel (Ref. Nos. 4 and 5). Place leg over holes so that edge of panel will be to the inside. On the top leg hole on each corner, use Ref. No. 19 10-24 x 3/4" screw (the longer screw). There are 8 longer screws (1 for top hole of each leg on each side of leg - 2 per leg). Longer screws are needed here if you are going to stack brooders. (See Step No. 18). Use Ref. Nos. 19, 21 and 22 fasteners at the top of each leg and use Ref. Nos. 20, 21 and 22 elsewhere.

**STEP 4:** Start the body assembly with the Feeder Side Panel (Ref. No. 4) and the Front Panel (Ref. No. 2). (This will insure that all units will be identical, and that the drinker is always in the front of brooder). Finger tighten Front Panel into the right leg that has been previously placed on the Front Panel.

**NOTE:** For easier assembly, turn unit upside down at this point so that all panels will rest on even edges.

**STEP 5:** Attach Side Panel (Ref. No. 5) leg with the other end of the Front Panel.

**STEP 6:** Insert Back Panel (Ref. No. 3) and attach to remaining holes.

**STEP 7:** Stand Unit upright on four (4) legs. Unit will be slightly unstable and will not stay square until more instructions are followed.

**STEP 8:** Attach three (3) Floor Bracing (Ref. No. 10) across assembly from one Drop Pan Channel (Ref. No. 13) to the other, using 10-24 x 3/8" screw and 10-24 nut, (Ref. Nos. 23 and 24), placing nut so that nut is on the inside of Drop Pan Channel (otherwise you will have trouble sliding floor screen in and out).

**STEP 9:** Place Angle Brace (Ref. No. 8) under the top lip of the unit and use Ref. Nos. 20, 21, 22 fasteners. Finger tighten nut from the underneath side. See Exhibit B for view of direction the forms should face. This is important for installation of Heating Unit (Ref. No. 18).

**STEP 10:** Visually adjust your assembly as close to square as possible. Start with tightening the locknuts placed on in STEP 9. This will help keep your unit in place while tightening the rest.

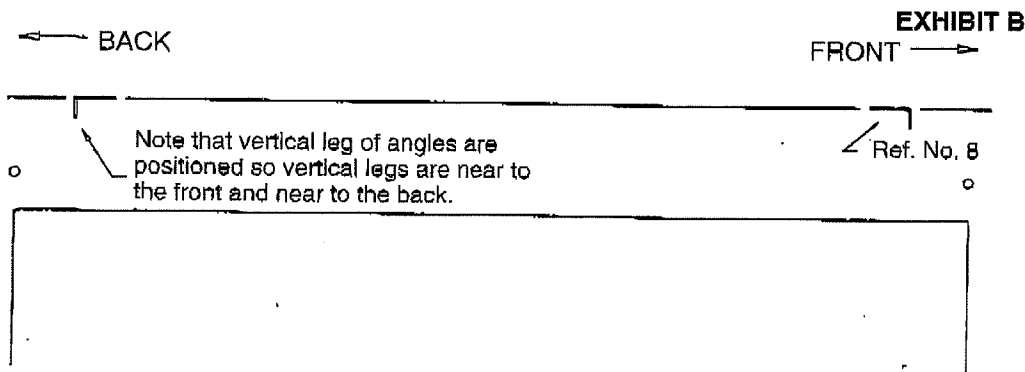

- STEP 11:** Start at any corner of the unit and tighten legs to the panels, making sure at all times that unit is as square as possible. **NOTE:** If you have purchased multiple units, and plan on stacking them, **DO NOT** tighten the top screw (Ref. No. 19) until you reach the stacking instructions in Step 18. This will save time later.
- STEP 12:** Place Floor Cross Bracing (Ref. No. 11) lengthwise on top of Ref. No. 10, with the bend at the front end, with the form sloping down toward the floor. Use Ref. Nos. 23 and 24 fasteners again placing nut on the underneath side of the bracings. Tighten all (15) screws.  
**NOTE:** If you purchased CQB600 Caster Base Assembly, it is recommended you install it at this point. Otherwise skip STEP 13 and proceed to STEP 18.
- STEP 13:** Turn unit upside down so that legs are facing upward. Using two (2) bolts, lockwashers and nuts (Ref. Nos. 32, 3, and 34) per bracing (Ref. Nos. 35 and 36), place bracing against the outside of the leg, second hole from the bottom. Insert bolt from inside the leg, through the bracing, add lockwasher and nut. After all bracings are connected, tighten. Caster Brackets (Ref. No. 29) fit over the bottom leg hole. Use two (2) carriage bolts and two (2) flange nuts (Ref. Nos. 30 and 31) on each bracket. Tighten as each Caster Bracket is assembled. Insert caster wheels (Ref. No. 28) into each caster bracket. Turn unit back to upright position.
- STEP 14:** Install the feed trough (Ref. No. 17) with three (3) adjustment screws and whiz nuts (Ref. Nos. 25 and 26). Slide bottom of feeder into rectangle slot next to the drinker, line up holes and tighten.
- STEP 15:** Slide the Drop Pan (Ref. No. 13) into the channels from the front of the brooder. Take the floor screen (Ref. No. 12) and slide on top of the floor bracing, also from the front end of the brooder.  
**NOTE:** For the smallest game birds (such as various species of quail), we recommend you cover the 1/2" wire mesh floor with paper towels or cage board for the first week or so. Do not use slick paper such as newspaper or magazine print. Also, we do have a 1/4" x 1/4" poly mesh which is precut to fit on top of the wire mesh floor but it is also long enough that it rounds out in all 4 corners. This mesh cover is an option. Order part number PM2742, Poly Small Bird 1/4 x 1/4 Mesh, 27" x 42 3/4".
- STEP 16:** You have two (2) each of window screens and window covers (Ref. Nos. 14 and 15). Width 6-1/2". **NOTE:** Covers are used to keep more heat inside unit in possible drafty areas. Use the option which will suit your needs best. Slide either screen or cover between window channels (Ref. No. 7) on the front and side panels. The back has a door cover only (Ref. No. 16). Width 6". Slide in same as windows.  
**NOTE:** If you purchased CGO20 Growout Pen, skip STEP 17.
- STEP 17:** Attach the BRHTR20 Heater Assembly (Ref. No. 18), through the back panel (Ref. No. 3). Slide completely in and attach far end with S-Hook (Ref. No. 27). S-Hook attaches to end of Heater and a single hole in the angle brace (Ref. No. 8). Thermostat Panel on the heater is fastened to the back panel with two (2) adjustment screws and whiz nuts (Ref. Nos. 25 and 26).
- STEP 18:** If you are stacking several brooders or growout pens (we recommend that you stack four (4) high but you can go five (5) high if desired), you should have the top screws (Ref. No. 19) on each corner (total of 8) still loose. After completion of your other brooders, remove these top screws. Set second brooder over the first. Legs on upper unit should overlap ones on bottom. With a little adjustment, all eight holes will be visible. Replace top screws and tighten. Repeat process on the next level.
- STEP 19:** Place two (2) sections of the top covers (Ref. No. 9) over edges of unit with centers overlapping.  
**NOTE:** If stacking units, insert top from side of brooder and then reaching through from front/back, lift edges and place lip over panel. Remove in reverse order.
- STEP 20:** See Instructions for CD100 Cage Drinker Trough Assembly and Bottle enclosed in drinker package.  
**NOTE:** You do not need to drill or cut a 2 inch hole as stated in STEP 1 of the drinker instructions. Use pre-existing hole.

### **NOTE CONCERNING USE WITH QUAIL AND OTHER SMALL BIRDS**

For the smallest game birds (various species of quail, etc.), we recommend you cover the 1/2" wire mesh floor with paper towels or cage board for the first week or so. Do not use slick paper such as newspaper or magazine print. Also, we do have a 1/4" x 1/4" poly mesh which is precut to fit on top of the wire mesh floor but it is also long enough that it rounds out in all 4 corners. This mesh cover is an option. Order part number PM2742. The description is Poly Small Bird 1/4 x 1/4 Mesh, 27" x 42 3/4".

## HEATER OPERATION

Model BRHTR20 uses a 250 watt Cal Rod with a reflector shield to transfer the heat to the floor of the brooder. It is thermostatically controlled. The heater uses 2 Model R7 7.5 Watt light bulbs. The bulb in the center of the brooder always stays on. The bulb near the thermostat at the rear of the brooder is the heating indicator bulb. It is on when the Cal Rod is heating. The heater assembly can be easily removed for thorough cleaning of the brooder. The heater uses our Model AT10 Adjustable Thermostat. Pertinent information about the thermostat is as follows:

UL recognized and CSA Approved (CSA-120 Volt A.C. only)

Ratings: 120 Volt A.C. 16.7 Amperes/240 Volt A.C. 8.3 Amperes

Description: HT open on rise. Controls heating applications by keeping contacts closed below the set point temperature.

Temperature Range: 70 degrees to 120 degrees F (21 degrees to 49 degrees C). The adjustment turns 180 degrees. Three degrees of turn is approximately equal to one degree F of temperature change. We suggest that you find the 180 degree range and set the switch at about the halfway point. Then adjust as necessary to find the appropriate brooding temperature. Turning the adjustment knob to the right (clockwise) increases temperature. See Exhibit C.

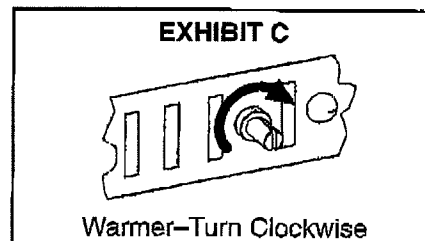

## BROODER OPERATING INSTRUCTIONS

Plug brooder cord into 110-220 volt A.C. circuit. Adjust thermostat as discussed above.

Start at 95 degrees F (35 degrees C) 1 inch above floor at a point in center of brooder chamber. Reduce heat by 5 degrees each week until chicks are transferred to finishing battery or growout pen.

Fill feeder full with no more feed than necessary to keep feed fresh daily. Always keep clean, fresh water for the chicks. Drop pan should be cleaned daily. To facilitate cleaning pans, cover them each time with newspaper or litter to absorb odors. Your water trough is self cleaning but you may want to periodically disinfect trough. Disinfect entire brooder each time chicks are transferred to aid disease control.

The drinker has sufficient capacity to water the chicks you have in the brooder. The capacity of the water bottle is more than the capacity of competing water troughs. However, you should still observe your chicks for any signs of dehydration - especially during the first few days--and add a supplemental 1 quart or 1 gallon drinker if you think is necessary.

Keep temperatures of the brooder room above 60 degrees F (16 degrees C) and provide ample ventilation without drafts.

**PLEASE NOTE:** In event of insufficient heat, call your power company and have them check the line voltage. A drop of ten volts will result in the loss of more than 20% of the heating power of your heater. Our experience shows that in most cases of low voltage, the line leading into the brooder house is too light and needs to be of heavier gauge. The greater the distance, from the meter to brooder, the larger the wires should be. Consult your power company for correct wire gauges to insure full voltage of 110-115 volts reaching the brooder.

**WHILE CLEANING, DISCONNECT POWER SOURCE AND REMOVE HEATER ASSEMBLY.**

## GROWOUT OPERATING INSTRUCTIONS

Our growout is designed for about 20-25 birds after brooding. For larger birds, you may want to consider Brower Model 4200, which has about 14 inches of headroom. Keep feed fresh by adding to the feed trough about the amount of feed that can be consumed in a day.

Always keep clean, fresh water for the chicks. Drop pan should be cleaned daily. To facilitate cleaning pans, cover them each time with newspaper or litter to absorb odors. Your water trough is self cleaning but you may want to periodically disinfect trough. Disinfect entire brooder each time chicks are transferred to aid disease control.

Keep temperatures of the brooder room above 60 degrees F (16 degrees C) and provide ample ventilation without drafts.

EXHIBIT A

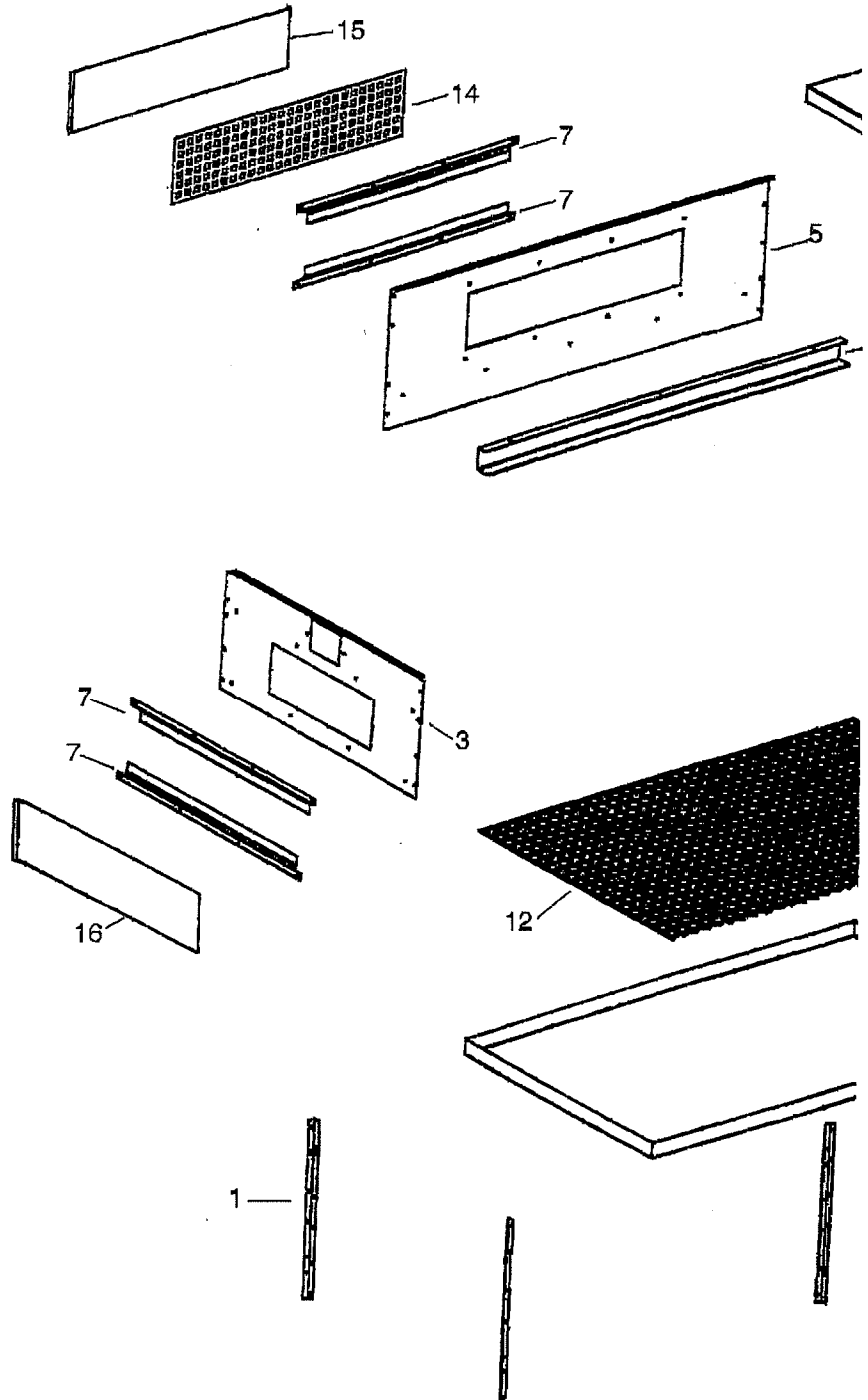

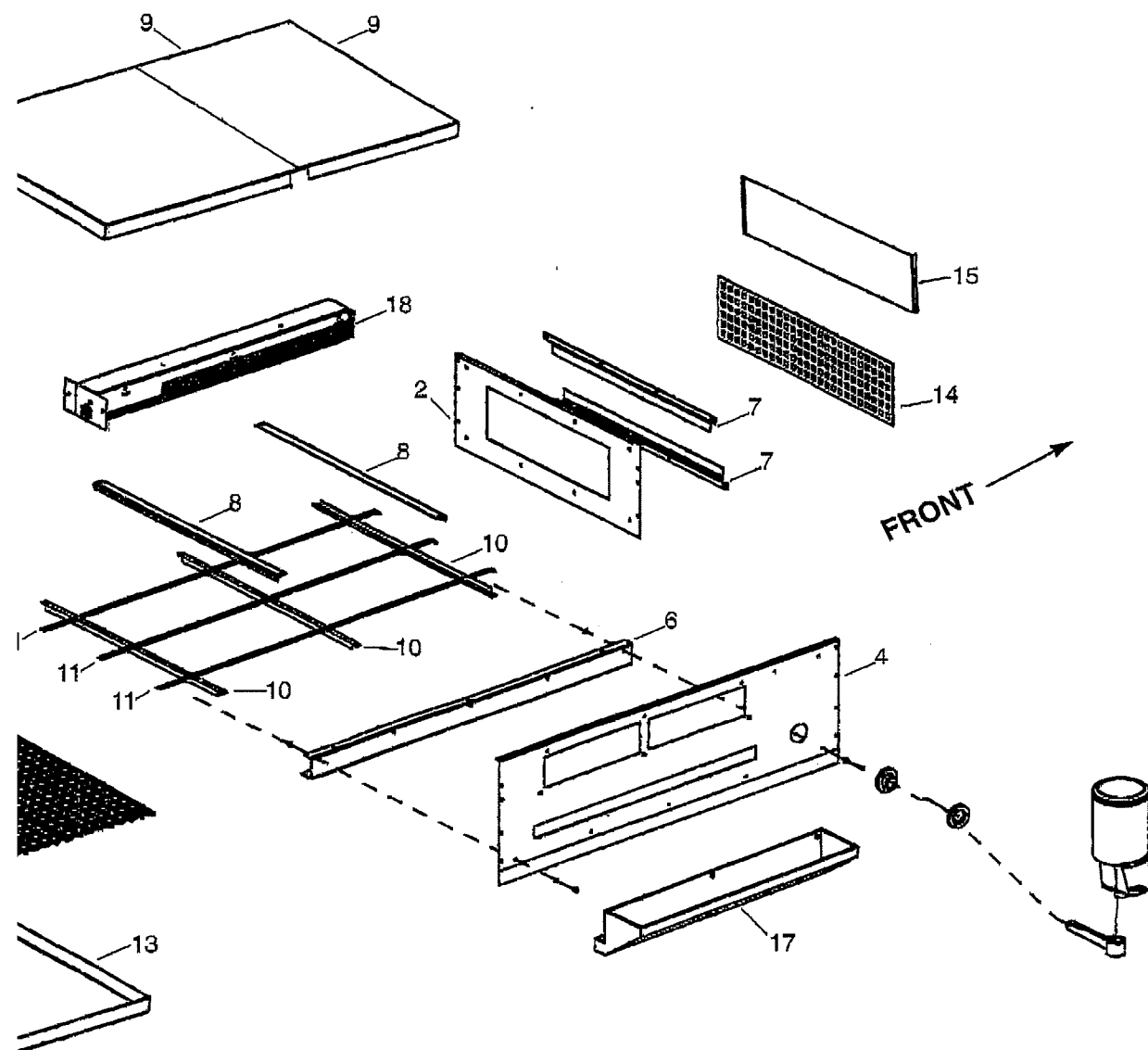

Ref. 22  
10-24  
Nuts go  
on the  
inside

Use Ref. Nos. 19, 21 and 22 fasteners in top holes (use the longer 3/4 screw in top hole at each corner)  
Use Ref. Nos. 20, 21 and 22